

4LSS6337E12B

(old # 4p-6337ADA1.25TD)



ADA COMPLIANT

DESCRIPTION

- 4-piece fiberglass showerstall smoothwall finish
- Complies with ADA minimum inside dimensions of 60"x30" for roll-in showers
- Sectional unit to allow for in-place assembly
- Front lip height of 1-1/4" allows for installation on top of the floor if used with the 12" ramp if existing building conditions prohibit recessing
- Full plywood backing
- Seat and/or grab bar as shown must be installed to meet ADA code
- Luxurious polyester Gelcoat finish in solid colors and available Sprayable Solid Surface
- Accessories available:
shower valve, matching soap dish, glide bar/hand shower, curtain and rod

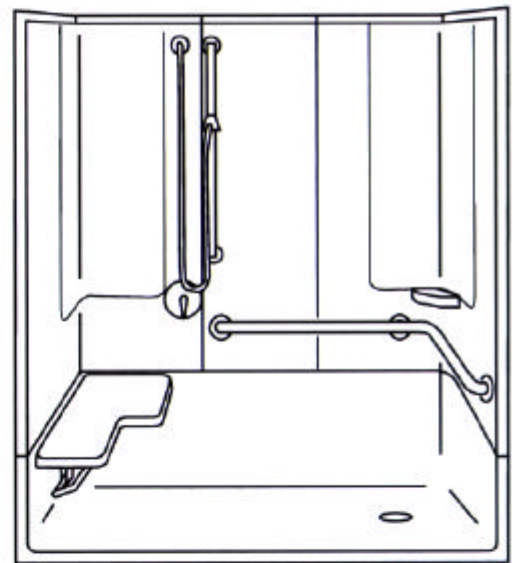
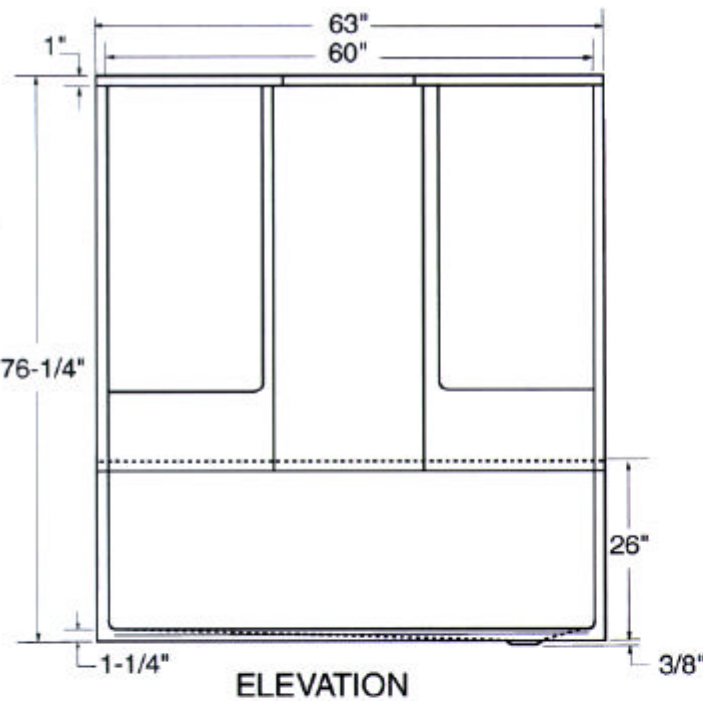
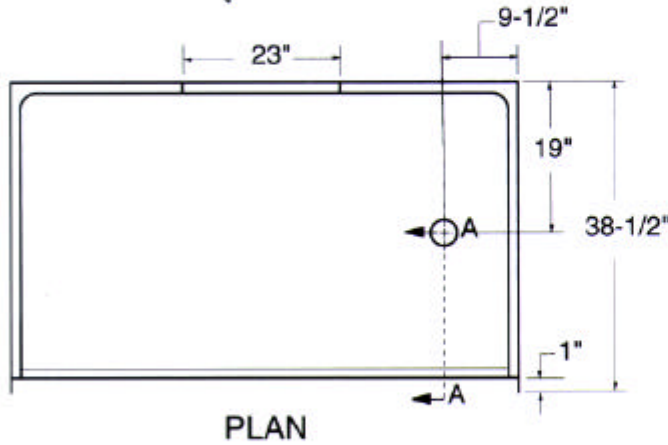

Shown here as "Right drain/Left hand seat/Left hand plumbing" model with optional fold-down seat, corner grab bar, soap dish, glide bar kit and valve.

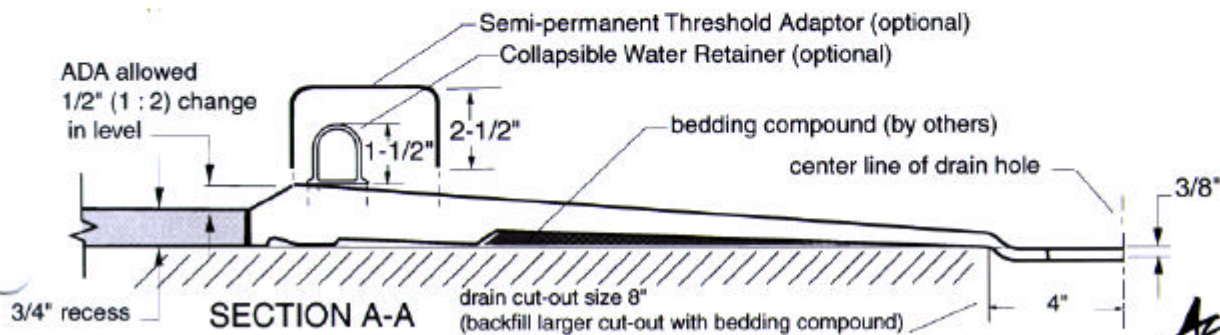

TITLE : 4-piece Roll-in Shower, smoothwall, A.D.A. compliant	SCALE : 1/2"=1'0"
MODEL : 4LSS6337E12B	SHT. 1 of 4